

MasterVision®

INTERACTIVE WHITE BOARD MANUAL



MasterVision®

Thank you for your purchase of a
Mastervision Interactive Whiteboard.

MasterVision®

4631 Johnson Road · Suite 7
Coconut Creek, FL 33073

Distribution

250 Grange Road
Savannah, GA 31407

T: 561-314-3970
info.us@bisilque.com

Table of Contents

What's in the Accessories Box	3
System Requirements	4
Recommended Software System	4
Introduction	5
How to Install Hardware	6
Set-up	12
How to use Annotation Software	13
Troubleshooting Guide	13
Specifications	14

What's in the Accessories Box

Thank you for your purchase of the Interactive whiteboard. If any items are missing or damaged, please contact the authorized reseller or call 1-888-269-0362.

P1 : 1 pc

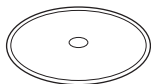

P2 : 1 pc
(Optional)



P3 : 1 pc
(Optional)



P4 : 1 pc

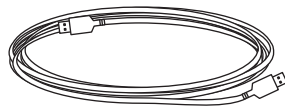

P5 : 8 pc

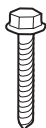

P6 : 8 pc



P7 : 1 pc



P8 : 1 pc



P9 : 4 pc



P10 : 1 pc

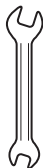

System Requirements

- Operating Systems: Windows®, Mac® and Linux®
- Interface: USB 2.0

Recommended Software System Requirements

Minimum requirements - Windows®:

- XP Service Pack 3
- 1 GHz Processor
- 512 MB RAM
- 400 MB free space

Minimum requirements - MAC®:

- Version 10.4 (Intel®)
- 512 MB RAM
- 500 MB free space
- 128 MB graphics memory

Minimum requirements – Linux® Ubuntu:

- Version 10.4
- 800 MHz Processor
- 512 MB RAM
- 500 MB free space
- 128 MB graphics memory
- Desktop effects enabled

Introduction

The Interactive whiteboard uses infrared technology. Working seamlessly with a projector and computer, the Interactive whiteboard provides more convenient, interactive and effective presentations. Perfect for school auditoriums, conference rooms, trade shows, symposiums and lecture halls. Users can write on the screen using the included pen, stylus or the user's finger.

- Writing: Write, draw and perform mouse functions with your finger. The whiteboard displays your penmanship instantaneously.
- Interacting: In video conferencing, both parties can share data and write in real time just like a standard conference room. Once integrated with Polycom or other video conferencing systems, using Interactive whiteboard can improve video conference results and efficiency.
- Touch Recognition: Can recognize touch of a single-finger, right-click, left-click and double click.

How to Install Hardware

1. How to install hardware

Install pen tray (optional):

Please find Nut Wrench on the box to perform this installation.

For the 96" version you'll have an additional nut and bolt to secure the tray.

01.

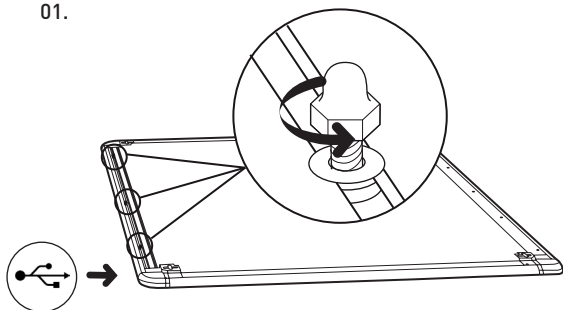

02.

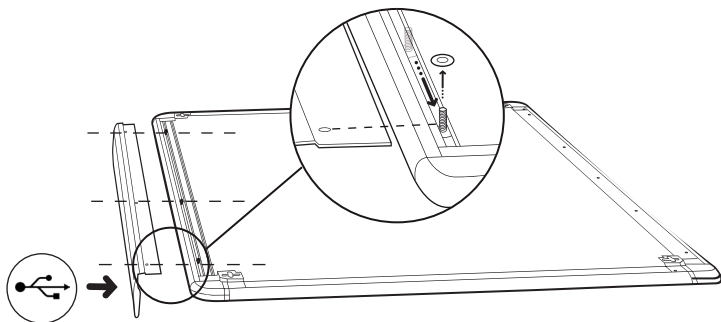

03.

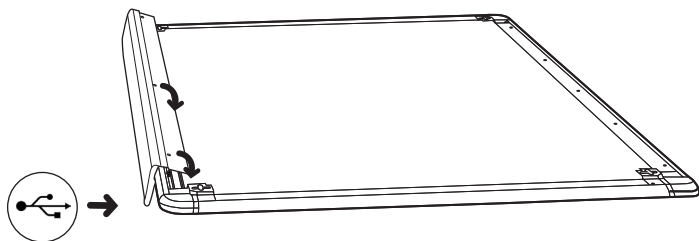

04.

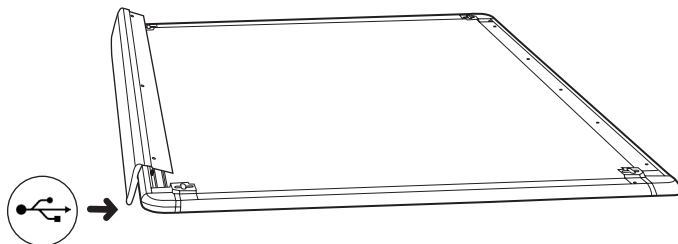

05.

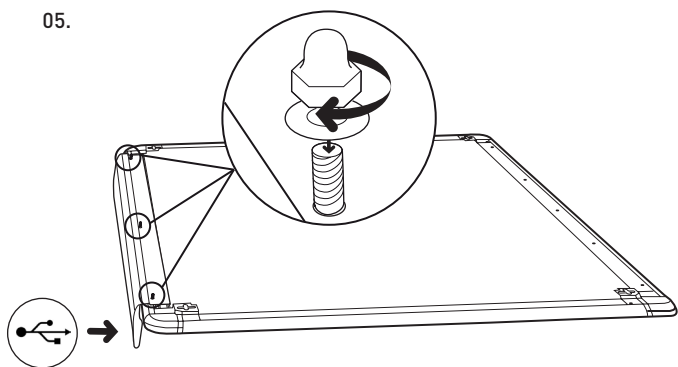

Wall mount:

We recommend the usage of the additional following tools:

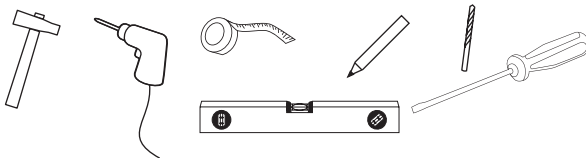

Additional Tips:

- use of an hexagonal head 0,4" / 10 mm wrench
- plastic covered gutter to hide electrical cables

	Dim 1	Dim 2
56"	51" / 1300mm	39" / 996mm
78"	70" / 1793mm	52" / 1326mm
96"	90" / 2285mm	52" / 1326mm

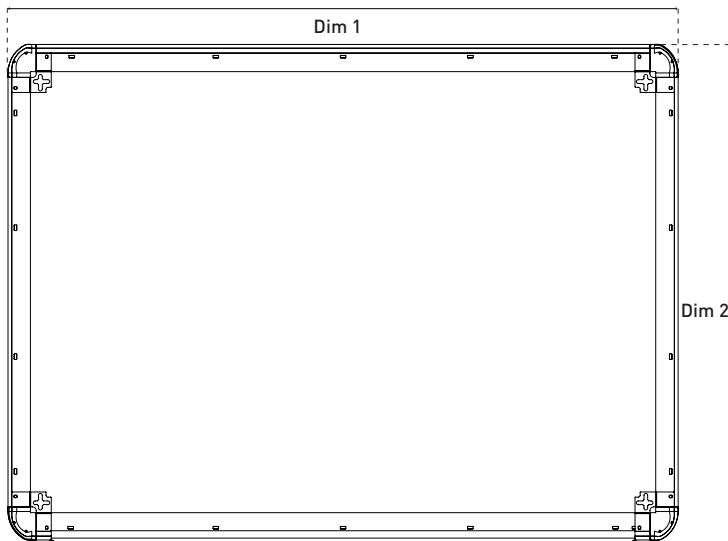

	Dim 1	Dim 2	Dim 3
56"	51" / 1300mm	43" / 1098mm	31.5" / 801mm
78"	70" / 1793mm	62.5" / 1591mm	44.5" / 1131mm
96"	90" / 2285mm	82" / 2083mm	44.5" / 1131mm

06.

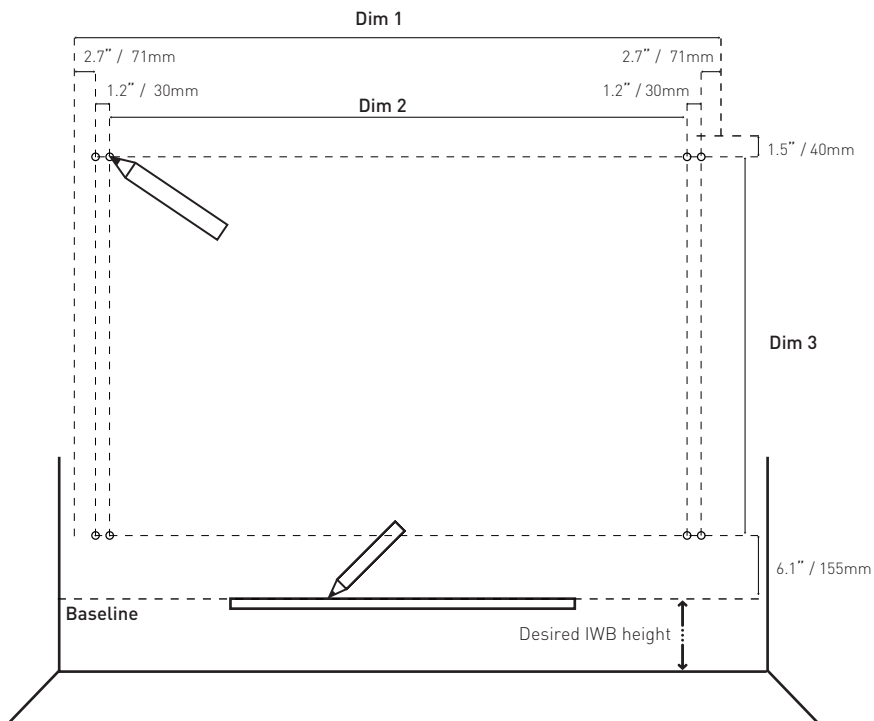

07.

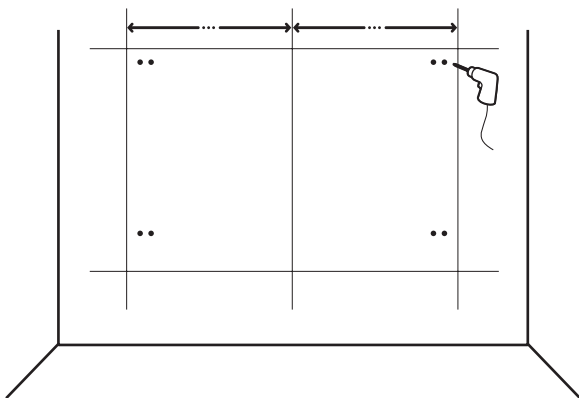

08.

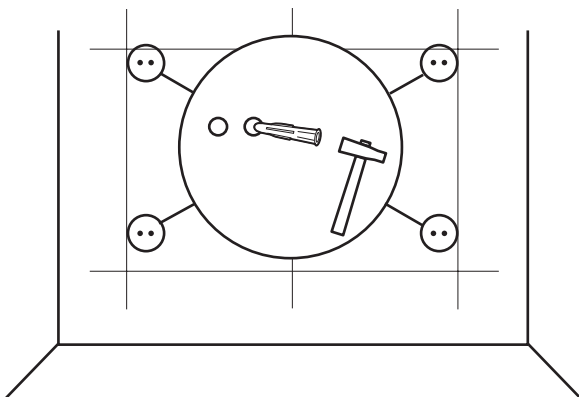

09.

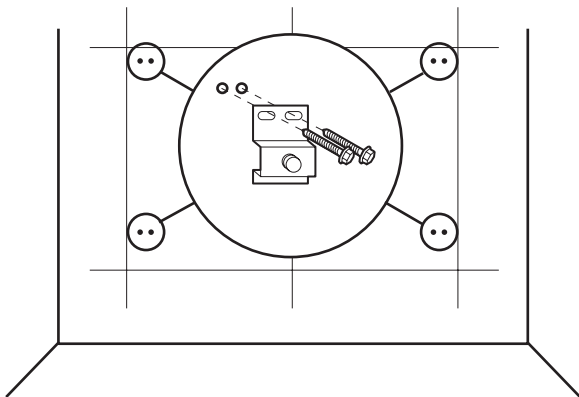

10. Confirm the correct position of the IWB.

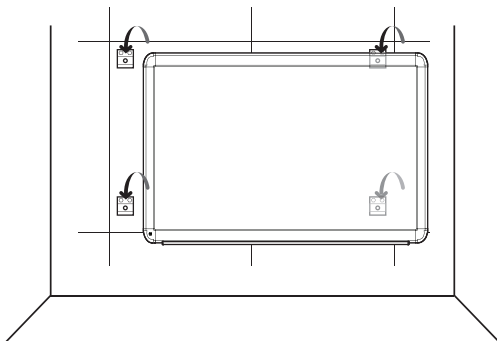

11. Consult your projector web site for the horizontal offset and vertical offset of the projector. Be aware that the projection surface is the white surface and not the IWB frame.

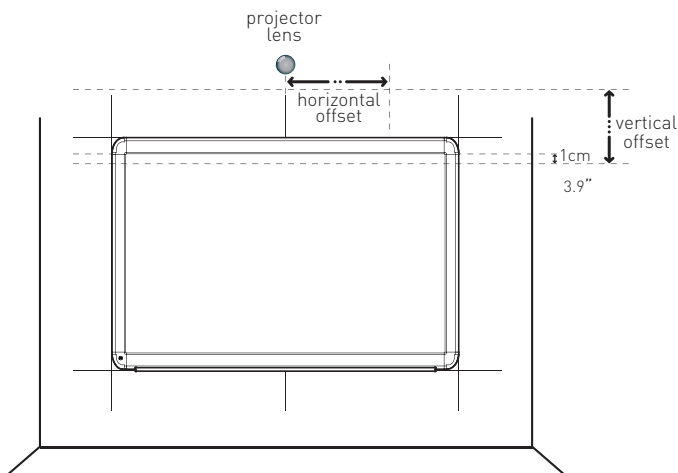

Sometimes the projector has its own arm but in the projector web site you will find the distances needed (until the projection surface).

Also the center of the lens must be aligned with the center line that you previously marked on the wall.

Be aware that the projection surface is the white surface and not the IWB frame.

12. Do not forget of the projector definitions (4:3 - 78" and 56" IWB, or 16:9 - 96" IWB).

Set-up

Plug & Play

No driver needed for running the IWB, just connect the computer. The Interactive Whiteboard is recognized as an HID device, once connected to the computer.

Mastervision Interactive Whiteboard, as embedded on its electronics, a SD Card, with 2 GB of memory allowing you to save information directly to the IWB.

It automatically opens each time that the IWB connects to a computer.

Please remember: before unplugging the USB cable please eject (Windows® and Mac®) or unmount (Linux®) USB device, using the tool bar icon. It is advisable to wait for the "Safe to remove hardware" command to appear.

Calibrating

STEP 1 - Users can calibrate image by opening the "eRed calibration tool.exe" file that is stored on the IWB SD card . The image must be all inside the whiteboard surface to be able to make the calibration.

STEP 2 - After opening this program, the image becomes black, with the point of calibration appearing in Yellow.



STEP 3 - Press in the centre of each calibration point. On the end, a message confirming the success of the calibration will appear.

STEP 4 - The Calibration is complete.

If the calibration does not complete successfully, please check that there is nothing blocking the IR signal in the IWB surface. The surface must be completely empty, meaning, nothing can be on it. Moreover, the projector image must be completely inside the white surface. Please leave at least 1cm distance between the projector image and the board frame (along the 4 sides). If still unsuccessful go back to step 1.

How to Use Annotation Software (optional)

For details, please refer to the software users manual on the CD.

Troubleshooting Guide

Problem	Reason	Try the following
The SD folder does not open in your computer	Failure of connection	Disconnect and reconnect the USB cable.
Blinking LED	Some LED's with problems	Disconnect the board, restart the computer and reconnect the board.
	USB port failure	
	USB cable failure	Check the whiteboard surface for objects that may be blocking IR signal.
Intermittent blink	Electronic failure	Disconnect the board, restart the computer and reconnect the board.
	USB port failure	
	USB cable failure	
No light	Connection error	Check all connections. Disconnect USB cable and connect again.
Unsuccessful calibration	LED blockage	Check that there is nothing blocking the IR signal in the IWB surface and that the projector image is completely inside the white surface (at least 1cm distance between the projector image and the board frame) along the 4 sides.

Specifications

	56"
Technology	Infrared
Touch System	Pen, Stylus or Finger
Touchable range	45" x 32" (1158mm x 828mm)
Resolution	4096 x 4096
Response Time	First dot: 25ms, continuous dot: 8ms
Cursor Speed	118" / 300cm /second
Coordinate Accuracy	3mm / 0.11"
Current Consumption	<225 mA
Port	USB
Dimensions	Without Pen Tray: 51" x 39" x 2" (1300mm x 996mm x 42mm) With Pen Tray: 51" x 40" x 4" (1300mm x 1008mm x 107mm)
Packing Dimensions	60" x 39" x 3.5" (1515 x 980 x 90mm)
Net Weight	15,7kg (35 lbs)
Gross Weight	22,6kg (50 lbs)
Accessories	Standard: Wall mount accessories, 1 pointer pen. Optional: CD with Interactive software, Pen tray
Operating Temp	5°F to 122°F (-15°C to 50°C)
Operating Humidity	20-90%
Storage Temp	-40°F to 122°F (-40°C to 50°C)
Storage Humidity	10-95%

78" Interactive Whiteboard	
Technology	Infrared
Touch System	Pen, Stylus or Finger
Touchable range	65" x 45" (1651mm x 1158mm)
Resolution	4096 x 4096
Response Time	First dot:25ms,continuous dot:8ms
Cursor Speed	118" / 300cm /second
Coordinate Accuracy	3mm / 0.11"
Current Consumption	<225 mA
Port	USB
Dimensions	Without Pen Tray: 71" x 52" x 2" (1793mm x 1326mm x 42mm) With Pen Tray: 71" x 53" x 4" (1793mm x 1338mm x 107mm)
Packing Dimensions	80" x 55" x 3.5" (2030 x 1400 x 90mm)
Net Weight	23kg (51 lbs)
Gross Weight	33kg (73 lbs)
Accessories	Standard: Wall mount accessories. Optional: CD with Interactive software, Pen tray
Operating Temp	5°F to 122°F (-15°C to 50°C)
Operating Humidity	20-90%
Storage Temp	-40°F to 122°F (-40°C to 50°C)
Storage Humidity	10-95%

96" Interactive Whiteboard	
Technology	Infrared
Touch System	Pen, Stylus or Finger
Touchable range	84" x 45" (2143mm x 1158mm)
Resolution	4096 x 4096
Response Time	First dot:25ms,continuous dot:8ms
Cursor Speed	118" / 300cm /second
Coordinate Accuracy	3mm / 0,11"
Current Consumption	<225 mA
Port	USB
Dimensions	Without Pen Tray: 90" x 52" x 2" (2285mm x 1326mm x 42mm) With Pen Tray: 90" x 53" x 4" (2285mm x 1338mm x 107 mm)
Packing Dimensions	99" x 55" x 3" (2520 x 1400 x 90mm)
Net Weight	27,9kg (61 lbs)
Gross Weight	39kg (86 lbs)
Accessories	Standard: Wall mount accessories, 1 pointer pen. Optional: CD with Interactive software, Pen tray
Operating Temp	5°F to 122°F (-15°C to 50°C)
Operating Humidity	20-90%
Storage Temp	-40°F to 122°F (-40°C to 50°C)
Storage Humidity	10-95%

MasterVision®

